

**WELCOME UROLOGISTS
TO OUR PRESENTATION OF
MIROVALVE[®] AUTOM. CATHETER VALVE
MADE IN GERMANY -
BRINGING THE PATIENT BACK
INTO SOCIAL LIFE**

Presentation is subject to copyright protection

MiroValve[®]

Automatic Catheter Valve

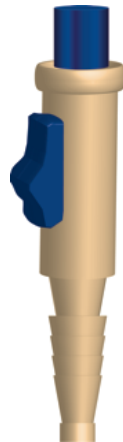

Presentation is subject to copyright protection

Design von Medizinagentur

www.mirovalve.de/en/home

What is a Catheter Valve?

- A catheter valve is a tap-like device, which fits into the end of the catheter (urethral or suprapubic). This can then be attached to a urinary drainage bag so that the valve lies between the end of the catheter and the drainage bag. The valve may be switched on or off to drain urine from your bladder or to stop drainage.

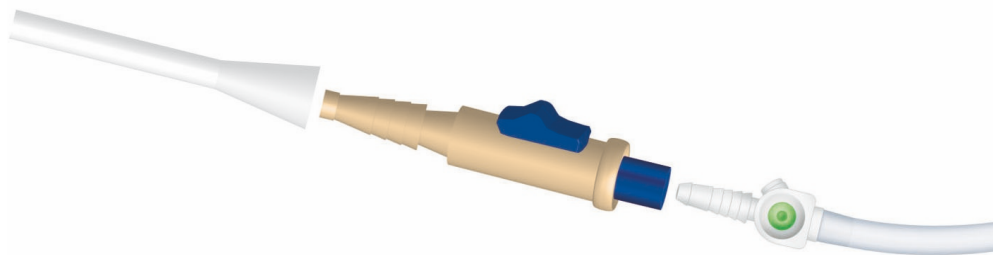

www.mirovalve.de/en/home

- Most patients who have a long-term catheter now use catheter valves. **MiroValve[®] is the Gold-Standard in Germany.** It is generally felt the bladder should not be kept empty at all times, because it has been shown that this reduces bladder capacity and tone.
- It is very important that the patient opens the valve and empties the bladder **when he feels the need to pass urine** or at least **four hourly**. The patient shall not leave his bladder overfull.

www.mirovalve.de/en/home

The aims of using a catheter valve are:

- To get the bladder used to holding a volume of urine again.
- To improve the capacity of the bladder.
- To get the bladder to hold between 300-500ml of urine.
- To have faster flow of urine to aid drainage of bladder debris.
- To have the catheter valve closed off all day, and for the patient to drain his bladder 4-5 times per day by opening the valve for a couple of minutes (or until drainage stops).

www.mirovalve.de/en/home

What are the benefits of a catheter valve for the patient?

- No need to carry a annoying and badly smelling urine bag in the daytime.
- Return of the patient to social life.
- A Valve is easy to wear in the underclothes.
- Good for bladder training during the daytime.
- No need to manipulate with a stopper on the catheter funnel with bare hands anymore, no urine on the hands.
- May reduce the risk of bladder infection and catheter blockage.
- More discreet than using a bag.
- Even for old/disabled people easy to manoever with one hand only
- Maintains normal bladder function.

Design von Medizinagentur

www.mirovalve.de/en/home

When should the patient open the valve?

- Whenever he feels the need to pass urine, before going to bed and first thing in the morning. He should release the catheter at least every 4 hours.
- When performing bladder training.

www.mirovalve.de/en/home

When does the doctor, nurse or patient change the valve?

- It is advisable to change the MiroValve[®] **together** with the foley or suprapubic catheter **at the same time**. MiroValve[®] is a single use medical device such as the catheter. The Mirovalve[®] should be changed every 3-5 weeks, depending on the encrustation level of the catheter. Follow the disinfection guidelines. If not directed by the treating physician, it is recommended to change MiroValve[®] latest approx. every 3-5 weeks. If the Mirovalve[®] is used more than 3-5 weeks, it is possible that because of the encrustation, the mechanism is damaged inside and the valve does not function properly.

www.mirovalve.de/en/home

Changing intervalls/catheter material advice

- Catheters with wide channels down the middle will take longer to block than those with narrow channels. One option is to either change to a larger size of catheter or, if you use a latex based catheter, **change to one made from 100% silicone**, as these have much wider channels.

www.mirovalve.de/en/home

Can the patient use Mirovalve[®] with drainage bags?

- The patient or nurse can connect the Mirovalve[®] to every common night bag. With the MiroValve[®] there is no need not remember to leave the valve tap open overnight. It is open automatically by connection with a bag. The night bag should be changed every 7 days.
- It is possible to use the Mirovalve[®] with a leg bag to drain the bladder in the day without need to find a toilet room.
- A leg bag strap or catheterretaining strap can be used for support if the underwear does not provide sufficient support for the catheter and valve.

www.mirovalve.de/en/home

What about personal hygiene?

- The patient or nurse should wash the area where the catheter is inserted each day. They should avoid using creams and talc around the area. The patient can bath or shower with the valve in place.
- The patient should drink enough as advised by the doctor.

www.mirovalve.de/en/home

Can the patient go on holiday?

- Yes of course. With the MiroValve[®] he is set free from urine bag in the daytime. He can go away but should make sure to take sufficient spares of all his equipment incl. MiroValves[®] for exchange to cover the time he is away. It may not be available elsewhere.

What is so special about MiroValve[®] Automatic Catheter Valve?



www.mirovalve.de/en/home

What are the benefits of MiroValve[®] the automatic catheter valve (Part 1)?

- The one and only automatic catheter valve world wide.
- Thanks to the automatic function when connecting a bag the patient can not forget to open or close the MiroValve[®]: This eliminates the risk of hydronephrosis after connection with a night bag and cares for a dry bed linnen after disconnection in the morning.
- Universal: Fits to every common catheter and every common urine bag regardless of size and material.
- No need to carry a annoying and bad smelling urine bag in the daytime.

Presentation is subject to copyright protection

www.mirovalve.de/en/home

What are the benefits of MiroValve[®] the automatic catheter valve (Part 2)?

- Return of the patient into social life.
- Good for bladder training during the daytime.
- No need to manipulate with a stopper on the catheter funnel with bare hands anymore.
- More discreet than using a bag in the daytime.
- More comfortable.
- May reduce the risk of bladder infection and catheter blockage.
- Maintains normal bladder function.
- MiroValve is patented and made in Germany.

Presentation is subject to copyright protection

www.mirovalve.de/en/home

Mirovalve video:

[https://www.youtube.com/watch?
v=1benpebNUq8&context=C38e449bADOEgsTo
PDsklZu2Zn0_DMbkMKteWG0tR1](https://www.youtube.com/watch?v=1benpebNUq8&context=C38e449bADOEgsToPDsklZu2Zn0_DMbkMKteWG0tR1)

www.mirovalve.de/en/home

Contraindications:

- Patient must have sufficient manual dexterity to push the slider of the valve to empty the bladder when required.
- The patient must have cognitive awareness and adequate bladder capacity to utilise these systems.

www.mirovalve.de/en/home

Safety advice/maintenance:

- Patient shall not use the MiroValve[®] more than 3-5 weeks. It is a single sterile medical product like the catheter. If the Mirovalve[®] is used more than 3-5 weeks, it is possible that because of the encrustation, the mechanism is damaged inside and the valve does not function properly.
- The patient should wear it continuously day and night on the catheter and never store the MiroValve in a alcoholic disinfection bath or other aggressive solution since the mechanism will suffer and can be damaged. Use only disinfection spray or disinfection wipes.
- Check from time to time if the catheter is working properly.

www.mirovalve.de/en/home

Summary

- MiroValve[®] is a Made in Germany product.
- MiroValve[®] has the CE, the European, Australian, Canadian, KSA, Russian and many other countries Ministry of Health Registration.
- It is the Gold-Standard catheter valve in Germany.
- It brings the patient back into social life.
- It enhances the quality of life of the patient significantly.
- May reduce the risk of infections.
- Excellent handling characteristics.
- Easy to wear in the underclothes.
- Manufacturing company has long experience in the field of urology products.

www.mirovalve.de/en/home

Packaging

- 1 box containing 10pcs. in single sterile packaging
- In every single sterile pouch there is an instruction for use
- Instructions are in multiple languages **incl. Arabic, Chinese, English, Spanish, Russian, French, Farsi, Italian, Japanese, Korean, Portugese, Russian, German, Greek, Turkish, Serbo-Croatian etc.**
- Shelf life: 5 years

www.mirovalve.de/en/index.html



Presentation is subject to copyright protection

Design von Medizinagentur

www.mirovalve.de/en/index.html

Clinical references (extract)

- Charité Berlin/Germany
- University Clinic of Heidelberg/Germany
- University Clinic of Mainz/Germany
- University Clinic of Würzburg/Germany
- University Clinic of Frankfurt/Germany
- University Clinic of Freiburg/Germany
- Private University Clinic of Salzburg, Austria
- AKH Wien/Vienna, Austria
- Klinikum Hirslanden, Switzerland

www.mirovalve.de/en/index.html

Literature

- Sowerby M. Nurse Prescribing. A guide for implementation. NHS Executive 1998
- Medical Devices Agency. Device Bulletin. The reuse of medical devices supplied for single use only. MDA DB 9501, London, January 1995
- Incontinence - Causes, management and provision of services. A Report of the Royal College of Physicians, London, May 1995
- NHS Executive. Incontinence (H185/002 1065 1AR). Department of Health, November 1996
- Getliffe KA. Bladderinstillations and bladderwashouts in the management of catheterized patients. J Adv Nurs 1996; **23**: 548-554
- Kennedy AP, Brocklehurst JK et al. Assessment of the use of bladder washouts/instillations in patients with longterm indwelling catheters. Br J Urol 1992; **70**: 610-615
- Ouslander JG, Greengold B, Chen S. External catheter use and urinary tract infections among incontinent male nursing home patients. J Am Geriatric Soc 1987; **35**: 1063-1070
- Pomfret IJ. Catheters: design, selection and management British Journal of Nursing 1996; **5**: 245-251

www.mirovalve.de/en/index.html

Questions?





Pfleiderer Medical Produkte GmbH

Copyright for this presentation:

MiroMed Pfleiderer Medical Produkte GmbH

Lindleystraße 12, 60314 Frankfurt am Main, Germany

Tel.: +49 69 489878-0

Fax: +49 69 489878-70

Email: mail@miromed.de

Presentation is subject to copyright protection